

WELLNESS STATION

WELLNESS-CHECK-3X3

89" w x 89" h non-magnetic frame with a straight fabric mural

The Wellness Station is a simple, collapsible display that assembles in minutes! Enlist employees, patrons and students to stop at the Wellness Station to check their temperature and disinfect – hands-free – prior to entry. The temperature gauge sounds an alarm if it exceeds 98.6 degrees Fahrenheit. The Wellness Station features Defender Stretch antimicrobial fabric, which inhibits the growth and spread of germs and bacteria.

Place the Wellness Check Station in every entrance and classroom and allow entry to only those who pass the temperature check.



features and benefits:

- Hands-free temperature gauge
- Battery operated, takes 3, AA batteries
- Hands-free 1000ml sanitizer dispenser w/ drip tray
- Dispenser requires 4 C batteries
- Protective coating on fabric graphic inhibits the growth of microorganisms, fungus, and bacteria
- Offered with or without end caps
- Alarm sounds if temperature exceeds 98.6° F

- Fabric graphic attaches with hook & loop
- 8ft wide (3 x 3 quad) straight collapsible frame
- Internal mounts hold temperature gauge and sanitizer dispenser in place
- Adjustable stabilizing feet
- Optional wheeled hard case
- One year limited warranty

dimensions:

Hardware

Assembled unit:
3x3: 89" w x 89" h x 12" d
2261mm(w) x 2261mm(h) x 305mm(d)

Approximate weight with cases:
3x3: 25 lb / 12 kg

Shipping

Packing case(s):
1 BOX

Shipping dimensions:
39" l x 22" h x 18" d
990mm(l) x 558mm(h) x 457mm(d)

Approximate total shipping weight
(includes Hardware & graphics):
37 lb / 16 kg

additional information:

Refer to related graphic template for more information
Visit: www.exhibitors-handbook.com/graphic-templates

Graphic material: Dye-sublimation power stretch hook and loop fastener fabric

Adjustable leveling feet on all bottom hubs of the frames

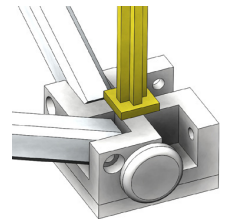

This product may include the following materials for recycle:
aluminum, select wood, fabric, cardboard, paper, steel, and plastics.

We are continually improving and modifying our product range and reserve the right to vary the specifications without prior notice. All dimensions and weights quoted are approximate and we accept no responsibility for variance. E&OE. See Graphic Templates for graphic bleed specifications.

*Not to scale

ASSEMBLE FRAME

INCLUDED IN YOUR KIT:



x1



x1

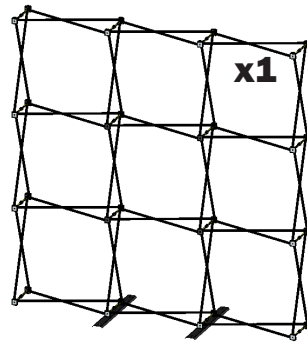

x1

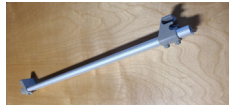

HOP-TEMP-ACC-KIT



HOP-HS-ACC-KIT

HOP-LITE-3X3-S



x1

WELLNESS-CHECK-3X3-SF-G

STEP 1:

Open the carry bag zipper. Carefully remove the frame with hook and loop fastener webbing from the carry bag. The fabric graphic may also be attached to the hook and loop fastener webbing. Stand the frame on the floor with the hook and loop fastener webbing facing up.

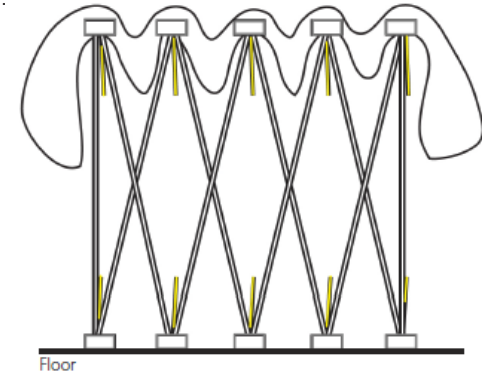

STEP 2:

Line up the female arm to the frame hub and push into place. Make contact when lining up the female arm and the frame hub for easier connection. Lock the arm into place by pushing the two sides of the frame together. The unit is assembled.



FEMALE MALE

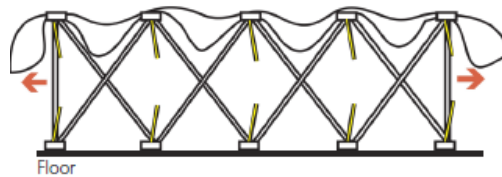

STEP 3:

With the frame laid out on the floor, attach the fabric graphic on the hook and loop fastener webbing. Use the numerical order shown in the image to the right. If the graphic is already hook and loop fastener attached on the webbing, skip to numbers 5 and 6 for the end cap attachment. Some hook and loop fastener adjusting may be necessary to eliminate the wrinkles. Only use numerical order 1 through 4 for fabric graphics with out end caps.

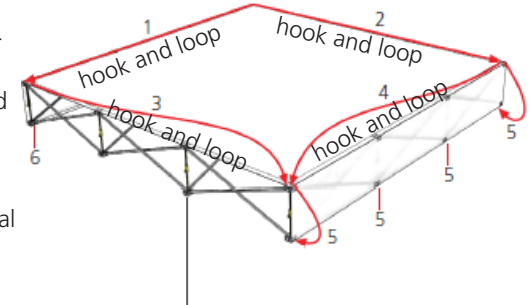

The hubs with adjustable leveling feet go to the floor and are the bottom end of the graphic artwork.

*Not to scale

ASSEMBLE FRAME

STEP 4:

Carefully stand the unit up flat on the floor. Use the adjustable leveling feet to balance it on uneven floors.

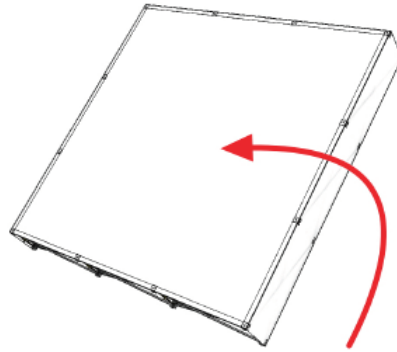
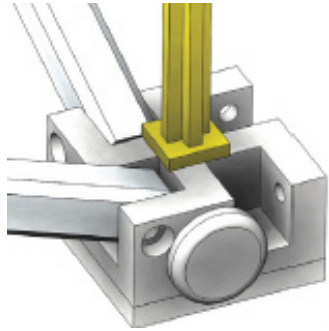

STEP 5:

Setup is complete for frame.



STEP 6:

Attach COY-MM support bars to both sides of Hopup-Lite frame. Loosen thumb screws to adjust plastic caps up & down for proper fit. Once support bar is in place. Tighten thumb screws.

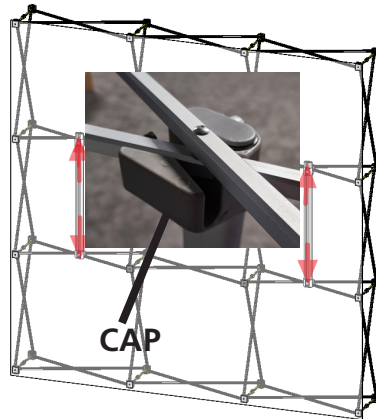

THUMB NAIL



STEP 7:

The unit **HOP-TEMP-ACC-KIT** needed for step 6. Insert assembled unit in slit in graphic. As you hold unit in place tighten cam-lock to secure and lock in place. You will need to position yourself where you can see front and back at the same time.



*Not to scale

ASSEMBLE FRAME

STEP 8:

Gather unit **HOP-HS-ACC-KIT** for this step. Insert PH through slit in graphic. With your left hand insert cam-lock into COY-MM channel. Once in place use right hand to tighten cam-lock. Do not over tighten. This could damage hardware.



STEP 9:

Completed Unit

