

Hanging Banner Frame Triangle/Square

Triangle item#’s: 210034 thru 210037 / 191050 thru 191053

Square item#’s: 210040 thru 210043 / 191037 thru 191040

Shared item#’s: 191027, 191064, 191066

Product Parts_Triangle

- 1 - Metal Pole (3', 4' & 5')*
- 2 - 60° Corner Angles (qty:6)
- 3 - Metal Connectors*

*Quantity is determined by product size

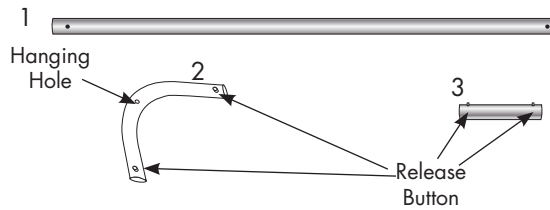

Product Parts_Square

- 1 - Metal Pole (3', 4' & 5')*
- 2 - 90° Corner Angles (qty:8)
- 3 - Metal Connectors*

*Quantity is determined by product size

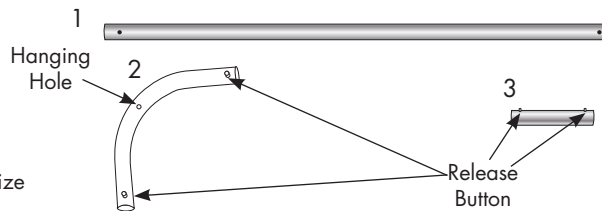

**Harness Sold Separately

Display Set-Up

Step 1

*If you are using the standard 3', 4' or 5' Metal Pole (1) lengths, skip to Step 2. If you are using a combination of the Metal Poles (1):

To assemble non-standard sides, insert a Metal Connector (3) into a Metal Pole (1) until the release button snaps into place. Then insert the Metal Connector (3) into another Metal Pole (1). Continue joining poles to make the appropriate lengths for all top and bottom sides of the frame.

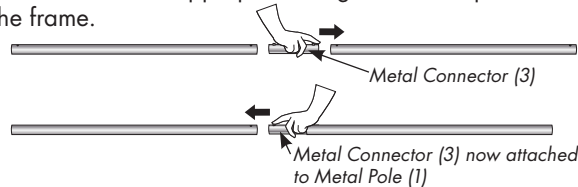

Step 2

Slide the Metal Poles (1) through the pole pockets in the top and bottom of each banner.

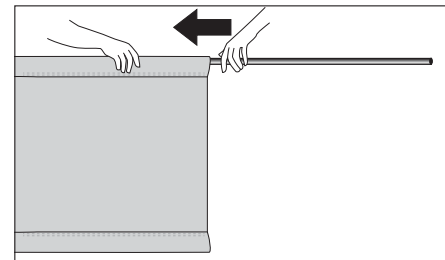

Example: If you are wanting a 6' square frame, join two 3' poles together with a Metal Connector (3) this will assemble ONE length of the side (repeat for bottom and all other sides)

Step 3

With banners now hanging on all the Metal Poles (1), insert the Corner Angles (2). Repeat for bottom corners. Triangle hanging banners will have three Corner Angles (2) per top and bottom. Square hanging banners will have four Corner Angles (2) per top and bottom.

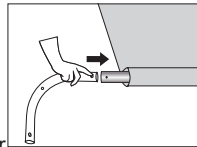

NOTE:

Framework is hung by a harness hole located in the 60°/ 90° Corner Angles (2). If more support locations are needed, you will need to cut more slits in the vinyl banner.

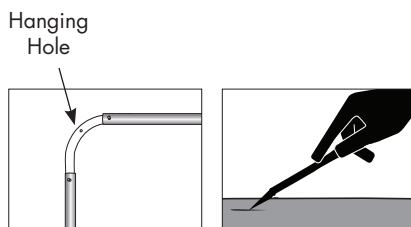

Top View of layout

this view is showing the frame only. Vinyl banners must be installed **BEFORE** putting on the Corner Angles (2).

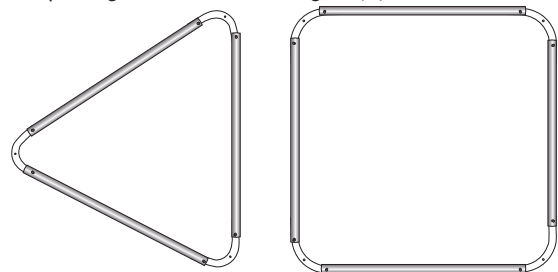

Storage and Care

Store parts in a cool, dry location. To clean, wipe with damp cloth.

Warranty Information: All products are designed to provide the user with a cost-effective and durable product. Standard warranty is a 'one year parts and labor' warranty which warrants product against defects in material and workmanship. It does not cover damage due to accidents, abuse, or normal wear and tear. Products found to be defective will be replaced or repaired at factory's discretion.